



## Mister Hitches 24 STAGE 4000kg ADJUSTABLE BALL MOUNT

Designed and developed by  
MISTER HITCHES AUSTRALIA.

The Mister Hitches Australia team has developed a very versatile hitch with a huge 24 adjustment positions. The shorter shank is suitability for the shallow towbar receivers eg. Ford Ranger (pre Next-Gen) & Pajero Sport. This hitch has a 25mm x 75mm ball platform and is one of only a few ball mounts which is suitable for the Stone Stomper. The hitch is fully reversible which gives you 24 mounting adjustments. Dual 9mm gussets a 5.75mm thick shank wall & H.T. 12.9 grade mounting hardware make this one of the strongest & most versatile hitches on the market.

### Features:

- G.T.W.: 4000kg T.W.: 400kg
- PIN HOLE TO BALL HOLE: 245/285mm
- PIN HOLE TO GUSSET: 60/100mm
- 24 ADJUSTABLE POSITIONS- FULLY REVERSIBLE
- DROP: 6-205mm RISE: 10-180mm
- 5.75mm THICK WALLED STEEL SHANK, ROBOTIC WELDED FOR STRENGTH.
- DUAL 9mm GUSSETS.
- HIGH TENSILE 12.9 GRADE BOLTS.
- SEAGUARD MATTE BLACK POWDER COAT FINISH GIVES SUPERIOR CORROSION PROTECTION.
- COMPLIES TO THE TESTING REQUIREMENTS OF ADR & AUSTRALIAN STANDARDS WHERE APPLICABLE.

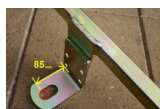

**Stone Stomper  
compatible**



**DO NOT OVERLOAD**

**THIS IS ANOTHER QUALITY  
MISTER HITCHES PRODUCT.  
MADE TO MISTER HITCHES SPECIFICATIONS  
MISTERHITCHES.COM.AU**

# ADJUSTABLE 4t BALL MOUNT

**24 STAGE ADJUSTMENT - REVERSIBLE  
HD SERIES 4000kg G.T.W.**

Part No. MHABM-HDX

MANY CUSTOMERS REQUIRE "MILLIMETER PERFECT" ALIGNMENT OF THEIR VEHICLE AND CARAVAN TO BE LEVEL SO THIS HITCH WITH IT'S 24 ADJUSTMENTS MOST TIMES WILL SUIT THEIR REQUIREMENTS.

**NEW**



### 24 ADJUSTMENT POSITIONS

**DROP: 6mm - 205mm  
RISE: 10mm - 180mm**

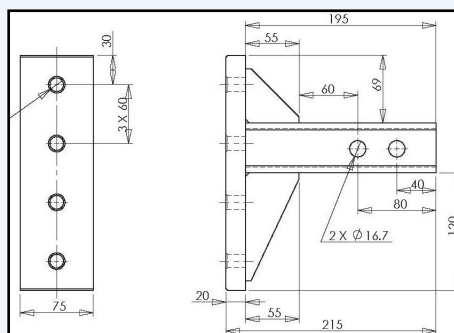
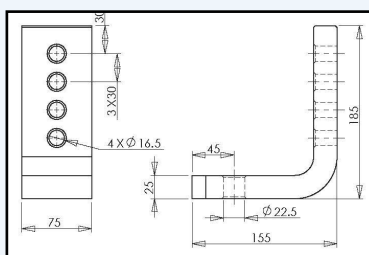

### ADJUSTMENT CONFIGURATIONS

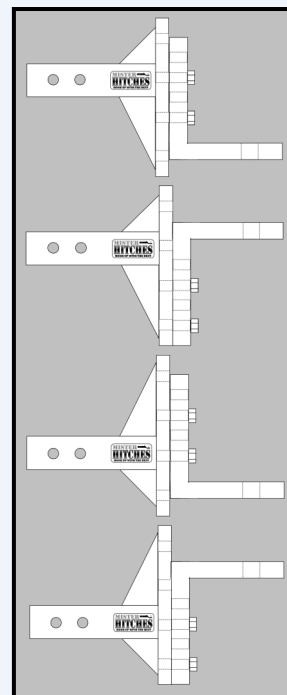

**intertrade**  
GLOBAL PRODUCT IMPORTS

INTERTRADE HOLDINGS PTY LTD  
UNIT 1, 2 TIDAL WAY BIBRA LAKE 6163 WA  
TEL: 08 9418 7044  
info@intertradedholdings.com.au  
www.misterhitches.com.au