

Winegard repair parts are available at many RV dealers and/or service centers nationwide. For the dealer nearest you, call 1-800-288-8094 or visit our website at [www.winegard.com](http://www.winegard.com).

## Sensar® RV TV Antenna Replacement Parts

**RVW-205** Amplified integrated Sensor/RV-WING antenna head. Requires 16" from boom to nearest obstruction for installation.

**RV-WING** Snap-on UHF upgrade for Sensor II and III antenna heads (*made after 1990*). Requires 16" from boom to nearest obstruction for installation.

**RV-2005** Amplified Sensor III antenna head where space from boom to nearest obstruction is less than 16".

**RP-2900** 2 Elevator tubes with 2 grommets / 4 pins / 4 retaining rings / adhesive rubber bumper

**RP-2000** Leveling mount / 4 spacers / 2 pins / 2 rings (*for models purchased before 1990*)

**RP-3000** Elevating gear

**FC-5932** RG-59 Weatherproof connector (12 pack)

**SA-1001** Ivory preassembled elevating shaft / gear housing / base plate

**RP-4000** Worm gear and 12.25" hex elevating shaft

(complete assembly including: wave washer / flat washer / o-ring / worm gear nut)

**RP-4014** Worm gear and 14" hex elevating shaft

(complete assembly including: wave washer / flat washer / o-ring / worm gear nut)

**RP-2049** Gear housing / 2 pins / bearing / o-ring seal / 2 retaining rings / nut

**RP-3523** Base plate / 10 screws / rubber boot

**RW-2000** Outside roof wedge (*used on slanted roofs*)

**IW-5012** Interior roof wedge (*used on slanted ceilings*)

**RP-0154** Boot (*only needed for Sensar I and II*)

**RP-6200** Ivory **RP-6300** White Directional handle / ceiling plate / 4 screws / spring (**RP-6822** included) / decal

**EK-1036** Directional handle extension (*fits RP-6200/RP-6300*)

**RP-6822** Spring

**RP-2658** Nylon bearing

**RP-5895** Ivory **RP-6795** White Crank / set screw / hex shaft

**RP-5000** Crank / set screw / round shaft

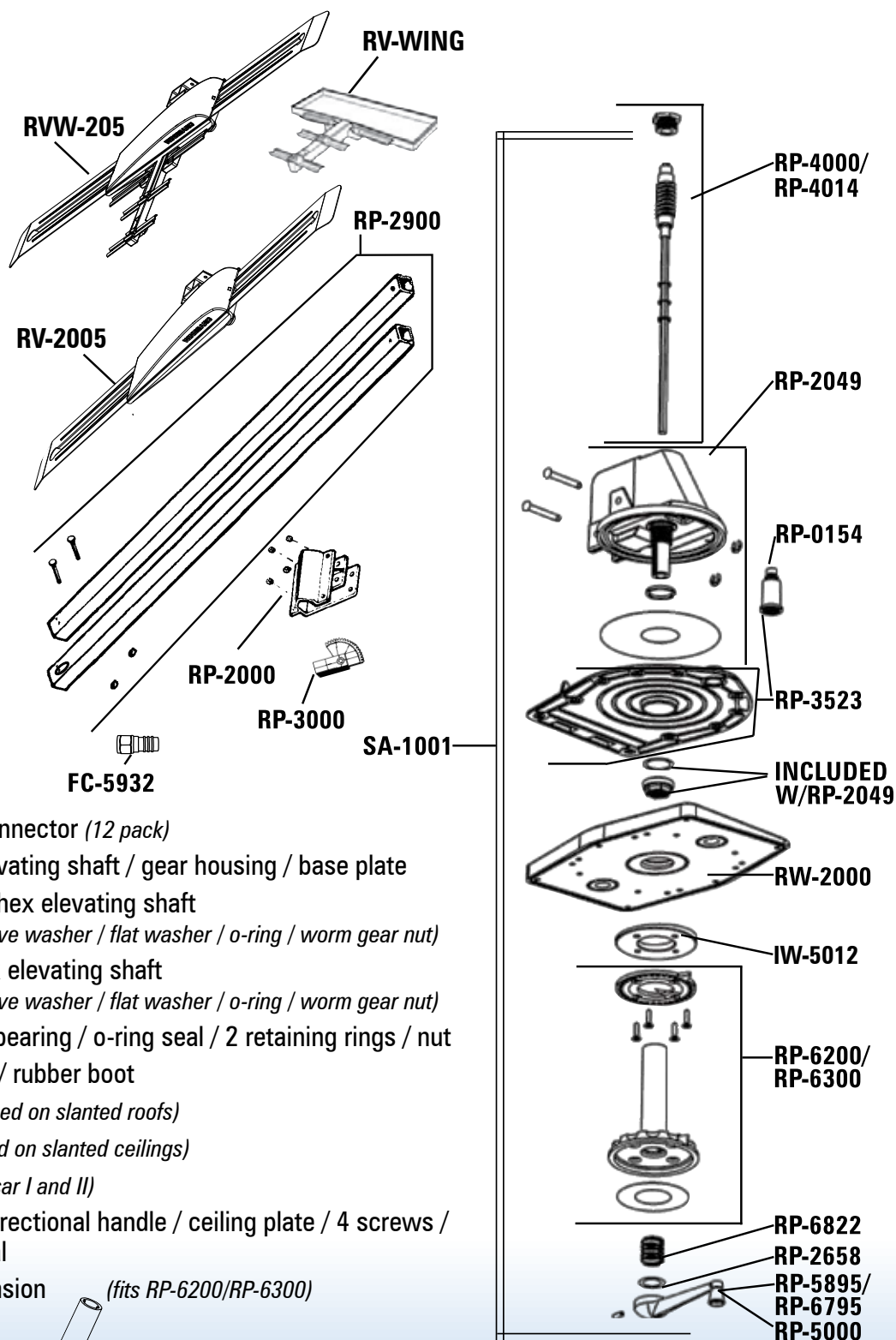

**WINEGARD®**